

# MODAL EXCITER

**PERFORMANCE**

Sine Force	13 (58)
Natural Air Cooling	
Max. Displacement	0.7 (18)
Continuous pk-pk	0.75 (19)
Mechanical Stops	DC-9000
Frequency Range <sup>1</sup>	>6000
Fundamental Resonance <sup>1</sup>	120 (3)
Maximum Velocity	
Acceleration <sup>1,2</sup>	32
Bare Table (w/collet)	16
0.5 lb (0.23 kg) load	8
2.5 lb (1.13 kg) load	200
Maximum Acceleration at Resonance	

**PHYSICAL**

Armature Weight	0.35 (0.159)
Suspension Stiffness	15 (2.6)
Rated Armature Current	9
Natural Cooling	
Stray Magnetic Field	<10
1.5 in (38 mm) above collet	<15
0.5 in (13 mm) from body	
Dimensions	8.65 x 8.82 x 4.25 (220 x 224 x 108)
Shaker Weight (with Trunnion)	13 (6)

5/16-24 mtg hole x 0.7 min Dp.  
(0.125 min dia. stinger into trunnion)  
0.025 dia mtg hole

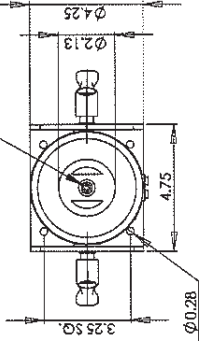

Collet Chuck adjustable:  
1/8 - 3/32 - 1/16 - 1/32  
Inches fine (no  
coarse) (0.0170 min.  
dia) (Optional 10-32 adapter included)

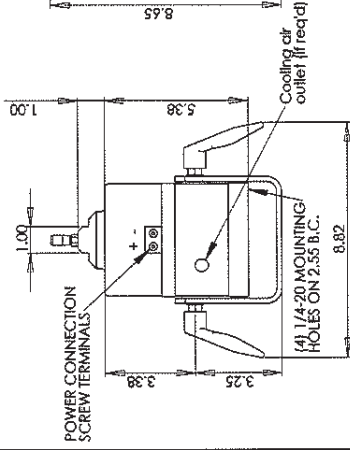
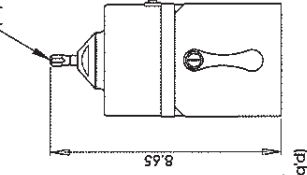

**RELATED EQUIPMENT:**

- 2100E21-400 SmartAmp™ Power Amplifier, voltage mode.
- 2050E05 Linear Power Amplifier, selectable voltage / current mode
- 2150G12 Modal Stingers, 1/16 in diameter rod with 10-32 threaded end, pack of three
- 2155G12 Modal Stingers, 3/32 in diameter rod with 10-32 threaded end, pack of three
- K2160G Plano Wire Stinger Kit, includes quick disconnect load cell adapter

**NOTES:**

- <sup>1</sup> Load dependent
- <sup>2</sup> Please see systems ratings for additional specs.

**SUPPLIED ACCESSORIES:**

- Qty 1 exciter cable
- Qty 1 2000X03 shaker accessory kit (with stingers)

**All specifications are at room temperature unless otherwise specified.**

ICP® is a registered trademark of PCB Piezotronics, Inc.

*In the interest of constant product improvement, specifications may change without notice.*

Project Engineer: **ATC**

Date: **8/22/17**

Product Manager: **WAR**

Date: **8/22/13**

Mkt Team Leader: **Shuo**

Date: **8/22/13**

Spec Number: **PS-0054**