

PCB Piezotronics Inc. claims proprietary rights in the information disclosed hereon. Neither it nor any reproduction thereof will be disclosed to others without the written consent of PCB Piezotronics Inc.

52262

| REVISIONS |                      |       |
|-----------|----------------------|-------|
| REV       | DESCRIPTION          | DIN   |
| NR        | RELEASED TO DRAFTING | 43770 |

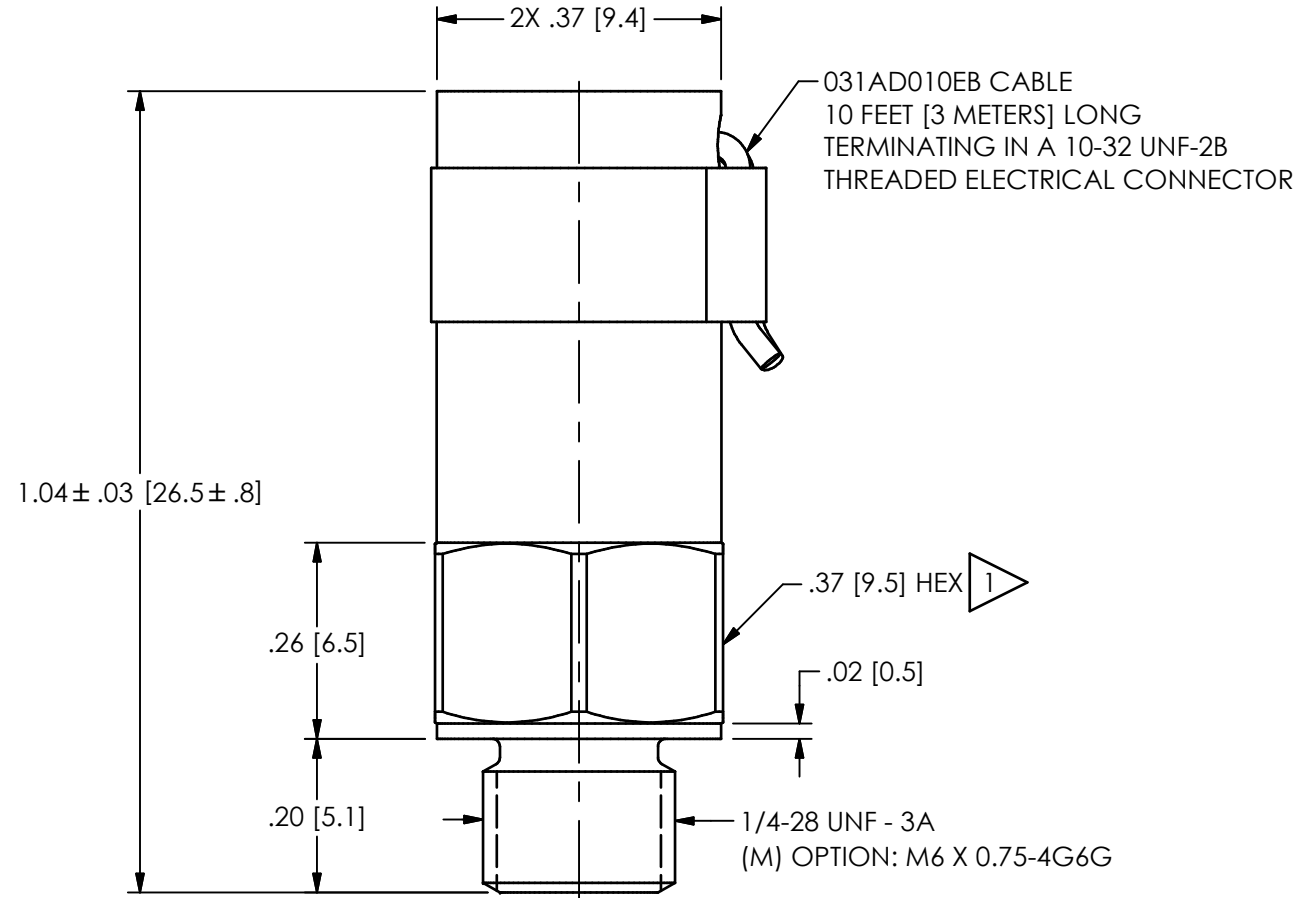

**MOUNTING HOLE PREPARATION**  
 Ø.22 [5.4]  $\nabla$ .30 [7.6] MIN  
 1/4-28 UNF-3B  $\nabla$ .20 [5.1] MIN

**(M) OPTION**  
 Ø.21 [5.9]  $\nabla$ .30 [7.6] MIN  
 M6 X 0.75-6H  $\nabla$ .20 [5.1] MIN

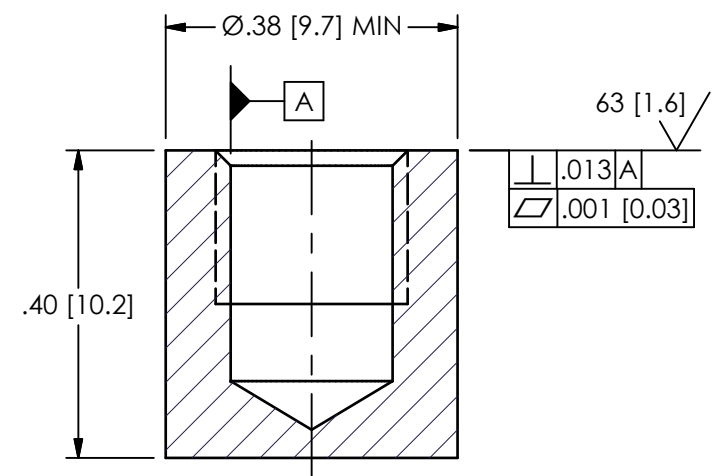

1 RECOMMENDED MOUNTING TORQUE ON .37 [.95] HEX 2.5-4 FOOT POUNDS [2.8-3.4 Nm].

| UNLESS OTHERWISE SPECIFIED TOLERANCES ARE: |   | DRAWN   |         | CHECKED           |         | ENGINEER               |         |
|--|---|---|---------|-------------------|---------|------------------------|---------|
| DIMENSIONS IN INCHES                       | DIMENSIONS IN MILLIMETERS [IN BRACKETS] | BB  | 2/12/15 | ECB               | 2/12/15 | AJA                    | 2/12/15 |
| DECIMALS XX ±.01<br>XXX ±.005              | DECIMALS X ±.03<br>XX ±.013             | TITLE<br>INSTALLATION DRAWING<br>MECHANICALLY FILTERED<br>SHOCK ACCELEROMETER |         |                   |         |                        |         |
| ANGLES ± 2 DEGREES                         | ANGLES ± 2 DEGREES                      |   |         |                   |         |                        |         |
| FILLETS AND RADII<br>.003 - .005           | FILLETS AND RADII<br>0.07 - 0.13        | CODE IDENT. NO.<br>52681  |         | DWG. NO.<br>52262 |         | SCALE: 4X SHEET 1 OF 1 |         |



3425 WALDEN AVE. DEPEW, NY 14043  
(716) 684-0001 E-MAIL: sales@pcb.com