

12222

PCB Piezotronics Inc. claims proprietary rights in the information disclosed hereon. Neither it nor any reproduction thereof will be disclosed to others without written consent of PCB Piezotronics Inc.

APPLICATION		
NEXT ASS'Y	USED ON	VAR

REVISIONS				
REV	DESCRIPTION	ECN	DATE	APP'D

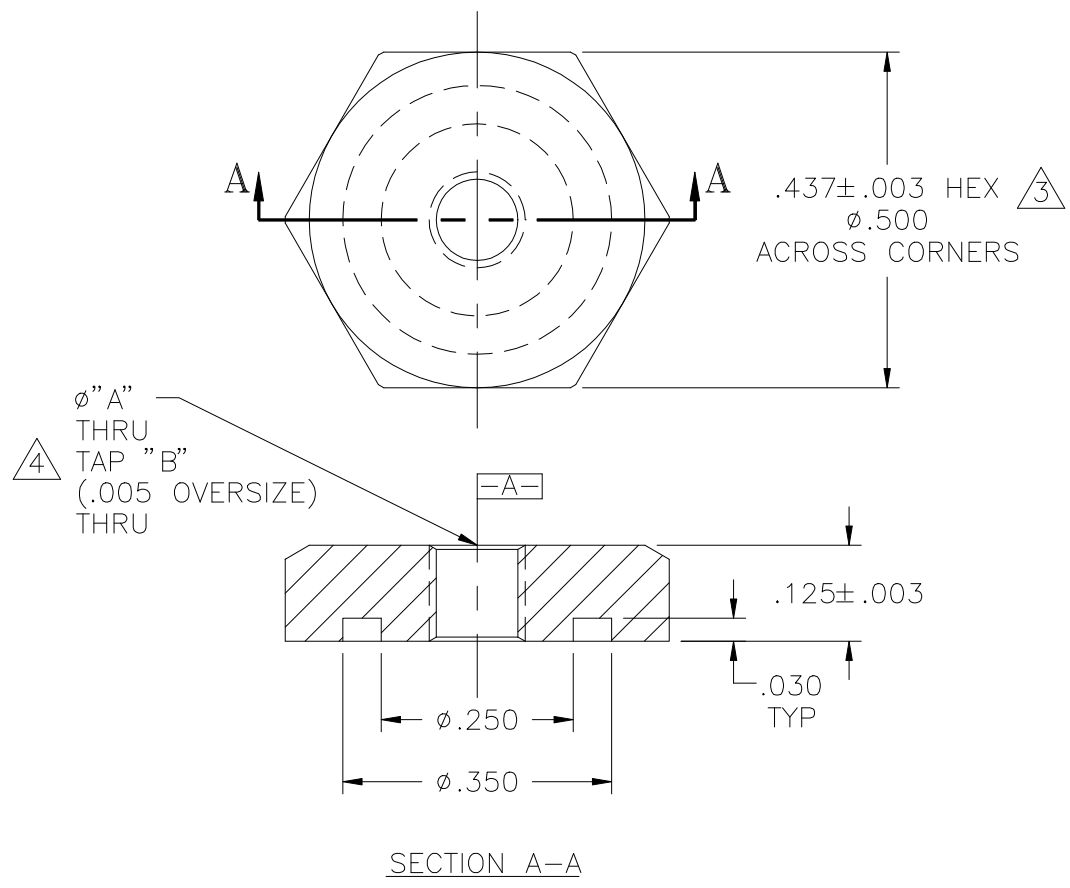

- 6.) INSULATION RESISTANCE TO BE $>1 \times 10 \Omega$.
- 5.) ALL DIMENSIONS ARE BEFORE HARDCOATING.
- ④ AFTER HARDCOATING, TAPPED HOLE MUST BE "B".
- ③ FLATS OR CORNERS OF HEX TO BE USED FOR CHUCKING DURING HARDCOATING.
- ② SANFORD HARDCOAT TYPE 3, CLASS 2, BLACK OR EQUIVALENT ALL SURFACES (.0010 TO .0015 THICK).
- 1.) ALL DIAMETERS TO BE CONCENTRIC TO $\boxed{-A-}$ WITHIN .005 TIR.

-02	.104	M3 X 0.5-6H	M080A25	12222-02
-01	.106	5-40 UNC-2B	080A25	12222-01
VAR	ø"A"	TAP "B"	MODEL	PART NUMBER

UNLESS SPECIFIED TOLERANCES
 DIMENSIONS ARE IN INCHES
 DECIMALS XX ±.01
 XXX ±.005
 ANGLES ±2 DEGREES
 FILLETS AND RADII
 .003 - .005

MATERIAL
 6061-T6
 AL ALY
 FINISH
 ② 32/

DRAWN
 MFG
 CHK'D
 ENGR
 APP'D
 TITLE
 ADHESIVE MOUNTING BASE

PCB PIEZOTRONICS INC.
 3425 WALDEN AVE. DEPEW, NY 14043
 (716) 684-0001 EMAIL: SALES@PCB.COM

CODE IDENT. NO. 52681
 DWG. NO. 12222
 SCALE: 4 X SHEET 1 OF 1