

250-0785-00

PCB Piezotronics Inc. claims proprietary rights in the information disclosed hereon. Neither it nor any reproduction thereof will be disclosed to others without written consent of PCB Piezotronics Inc.

APPLICATION

| NEXT ASS'Y | USED ON | VAR |
|-------------|---------|-----|
| | M303A | -01 |
| 303-9210-00 | 303M21 | -01 |
| 303-1130-00 | 303A13 | -01 |
| | 303M75 | -01 |
| 303-9820-00 | 303M82 | -01 |

REVISIONS

| REV | DESCRIPTION | ECN | DATE | APP'D |
|-----|-----------------|-------|----------|-------|
| H | UPDATE NOTES | 10983 | 10/12/99 | |
| J | CHANGE MATERIAL | 11408 | 1/27/00 | |

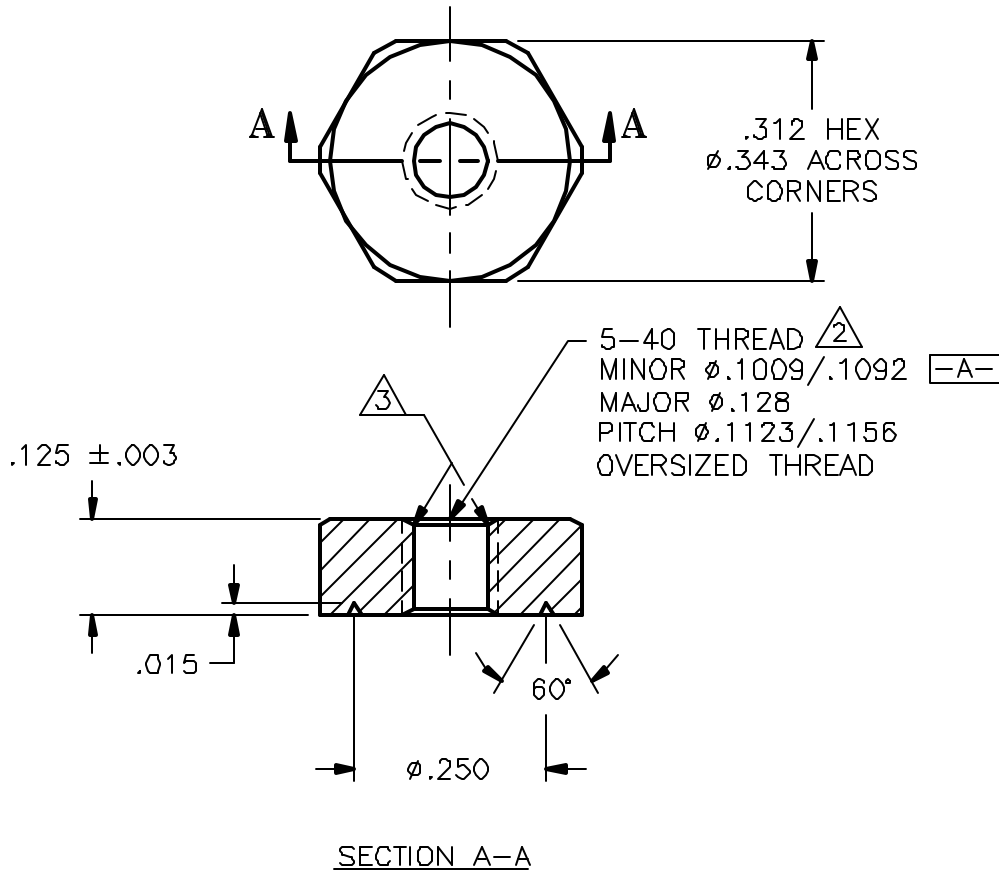

5.) ALL DIAMETERS CONCENTRIC TO ^{-A-} TO WITHIN .005 T.I.R.

⁴ SANFORD HARDCOAT TYPE 3, CLASS 2, BLACK OR EQUIVALENT (.0010 TO .0015 THICK).

³ HOLD PART BY INTERNAL THREAD (NEAR TOP) WITHOUT TOUCHING TOP SURFACE FOR HARDCOATING. IT IS CRITICAL THAT THE BOTTOM, TOP, AND EXTERNAL SIDE SURFACES ARE HARDCOATED.

² AFTER HARDCOATING, TAPPED HOLE MUST BE 5-40 UNC-2B.

1.) ALL DIMENSIONS BEFORE HARDCOATING.

| | | |
|-----|--------|-------------|
| -01 | 080A15 | 250-0785-01 |
| VAR | MODEL | PART NUMBER |

| | | | | |
|--|------------------------|-------|----------------------------|---|
| UNLESS SPECIFIED TOLERANCES DIMENSIONS ARE IN INCHES DECIMALS XX ± 01 XXX ± .005 ANGLES ± 2 DEGREES FILLET AND RADII .003 - .005 | MATERIAL 2024 | DRAWN | MFG | 3425 WALDEN AVE. DEPEW, NY 14043 (716) 684-0001 EMAIL: SALES@PCB.COM |
| | HEAT TREAT | CHK'D | ENGR | |
| FINISH ⁴ 32/√ | TITLE MOUNTING BASE | | CODE DENT. NO. 526B1 | DWG. NO. 250-0785-00 |
| DD007 REV. B 03/13/98 | | | SCALE: 4 X | SHEET 1 OF 1 |